

TSB REVISION NOTICE:

- **October 3, 2006:** The seat set has been removed from the Parts Information table.
- Previous versions of this TSB should be discarded.

Introduction Some customers may complain that the cover on the side of the seat back pulls away from the bezel for the access lever or reclining adjuster lever. Parts have been modified to correct this condition. Please refer to the following repair procedure to correct affected vehicles.

- Applicable Vehicles**
- **2005 – 2006** model year **Scion tC** vehicles produced **BEFORE** the Production Change Effective VIN shown below.

MODEL	PRODUCTION CHANGE EFFECTIVE VIN
Scion tC	JTKDE1#7560104108

PREVIOUS PART NUMBER	CURRENT PART NUMBER	PART NAME	QTY
N/A	72054-21010-B0	Lever Sub-assembly, Reclining Remote Control	1

OP CODE	DESCRIPTION	TIME	OFF	T1	T2
BD5034	R & R Adjuster Bezel	0.7	71074-212*0-B0	67	57

Applicable Warranty*:

This repair is covered under the Toyota Comprehensive Warranty. This warranty is in effect for 36 months or 36,000 miles, whichever occurs first, from the vehicle's in-service date.

* Warranty application is limited to correction of a problem based upon a customer's specific complaint.



**Repair
Procedure**

1. Remove the reclining adjuster release handle.

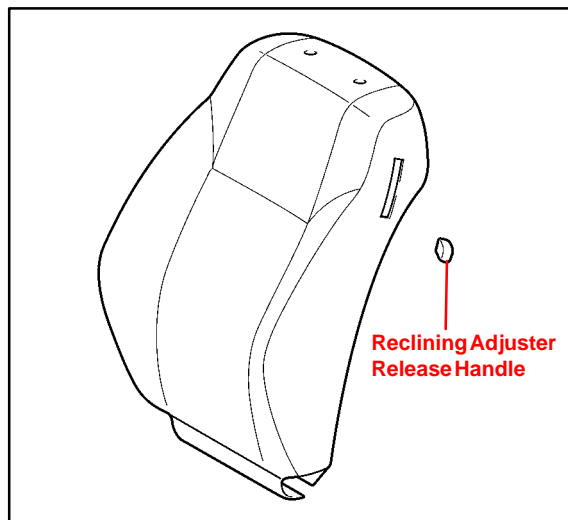

2. Remove the reclining control bezel.

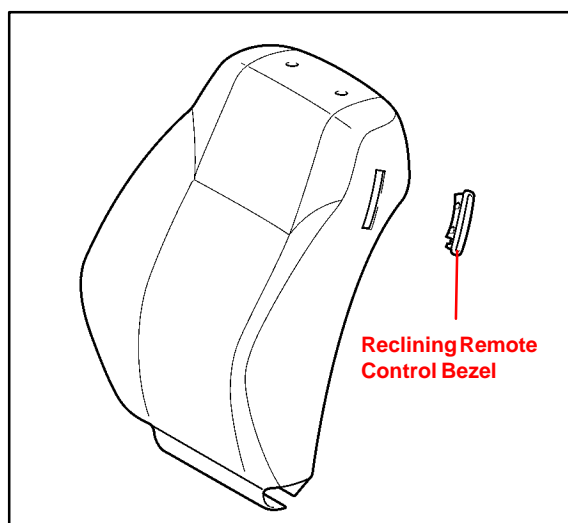
**NOTE:**

- Gently pull the control bezel to remove.
- Be sure to NOT damage the bezel during removal.

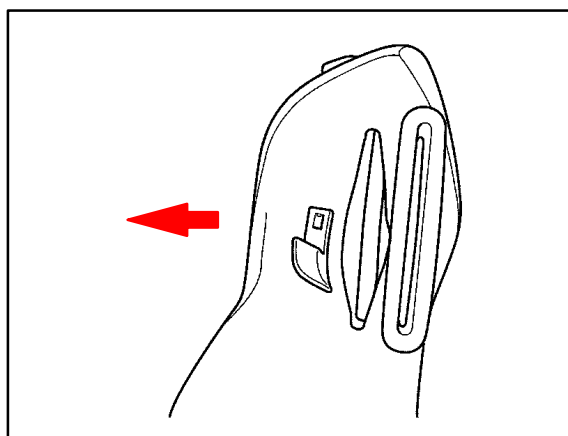

**Repair
Procedure**
(Continued)

3. Apply double-sided tape to the seat pad for the front seat back cover fitting (for front and rear).
Apply the double-sided tape along the outer edge of the seat pad opening.

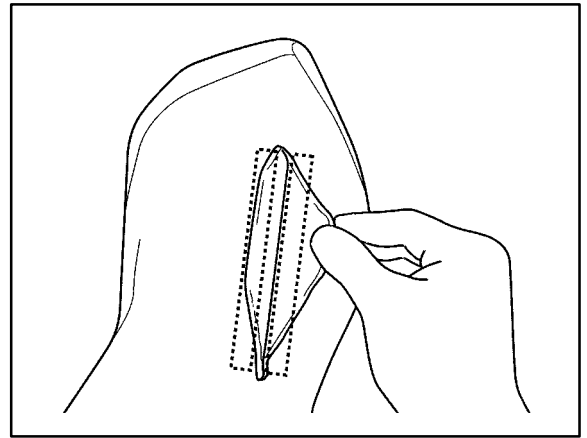

4. Carefully remove the backing from one side of the double-sided tape.

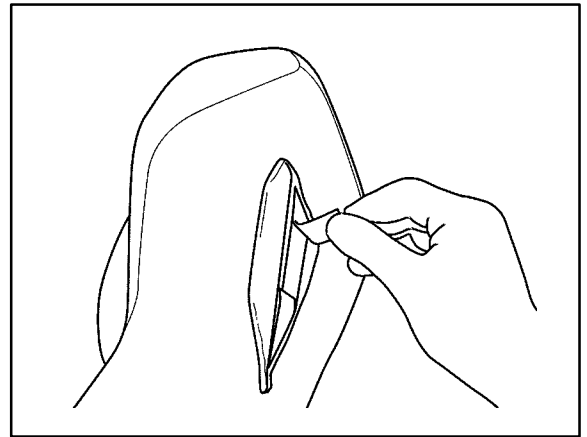

5. Press the front seat back cover against the tape adhesive side.

NOTE:

- Do NOT attempt to remove the tape once applied to the cover.
- Do NOT reuse the tape if removed once.

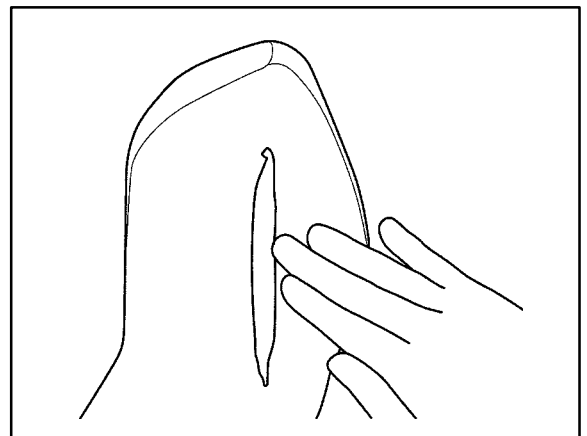

**Repair
Procedure**
(Continued)

6. Install the reclining control bezel by pressing it firmly into place.

NOTE:

Allow it to set for 30 minutes for proper adhesion.

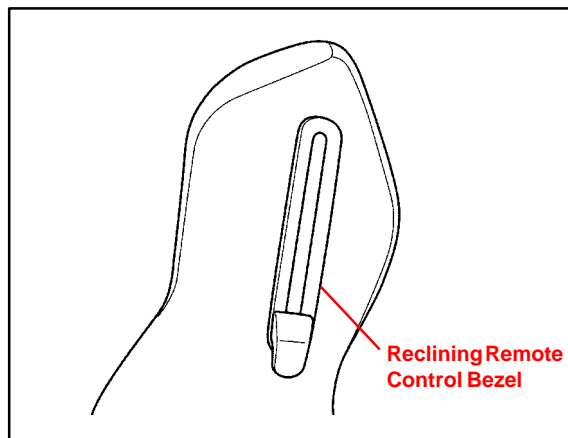

7. Install the NEW reclining adjuster release handle.

NOTE:

Since the reclining adjuster release handle may be deformed when removing, do NOT reuse the original reclining adjuster release handle.

